

Ver. 1

INVEST IN TIME



TRUCKS



FUEL HANDLING

SPECIAL TOOLS

FOR TRUCK, BUS AND TRAILER

WALLMEK
í Kungälv AB

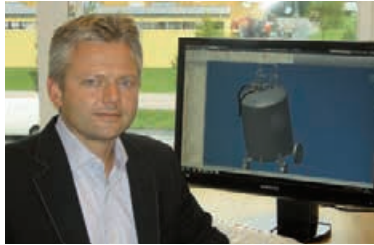

Company profile:

Wallmek i Kungälv AB was started in 1978, producing and designing special tools for car repairs. Wallmek stands for idea and design of tools, up to delivery of a complete product to the customer. Our products are in the segments of chassis tools and liquid handling equipment.

The Wallmek research and development department works in close cooperation with automotive workshops to ensure the best possible productivity, ergonomics and health. We are very good at designing hydraulic tools that enable repairs directly on the car, handling of fuel when tank repairs are necessary and to make drainage systems for car dismantlers. Today Wallmek is developing tools directly for car manufacturers, after market and garages. For the car dismantling industry, we develop tools for draining all liquids from the cars to make them environmentally decontaminated.

As the company continues to expand, we are now also involved in customer segments like trucks, trailers and constructions machinery. In short terms – we develop Wallmek in a direction where our products make the best use for our customer.

Our mission:

To develop, produce and market our cost effective tools to our customers.

Important for us:

Quality! – To exceed the customers expectations.

Design! – Ergonomic, well thought out and functional products.

Customer care! – Being present and always available for support.

Welcome to Wallmek i Kungälv AB

Niklas Wallman
Managing Director

The information “patent pending”, regarding patent applications for certain products in this brochure, only concerns the patent application Nos. (and markets covered by that patent application) explicitly stated in the immediate connection with patent pending indication.



Labourtime



QR code video



Position on vehicle

04-00028 Hydraulic ball-joint puller, 8,8 ton

New and unique design that efficiently presses out the ball joints and brake/slack adjuster on trucks, busses and trailers. Also wheel bolts are dismounted and mounted very smoothly thanks to the flexible design (see pictures below).

The press tools can be rotated for different ground heights, the two supplied distance rings provide the adjustment options required for these jobs. The anvil tool has an opening of 42 alt 57 mm depending on what side is chosen. In addition, the two tools can change position on the cylinder for superior access in tight areas inside the wheelhouse, around sway bars or hidden steering joints on buses, etc.

The hydraulic cylinder presses up to 8.8 tonnes for easy, safe and smooth removal. A safety belt is supplied with the tool to prevent the tool from falling down during work.

Used with 700 bars of hydraulic pump 1030, or 1036.

Pat Pending No. EP17179578.4 and US Patent Application 16/021.868



Parts in the set:

1. 04-00028-021 – Press tool
2. 04-00028-022 – Anvil tool
3. 04-00024-019 – Distance ring 16 mm
4. 04-00028-020 – Distance ring 26 mm
5. 04-00028-011 – Safety strap
6. RES4305 – Hydraulic quick-coupling male 1/8"



Dismounting wheel bolts

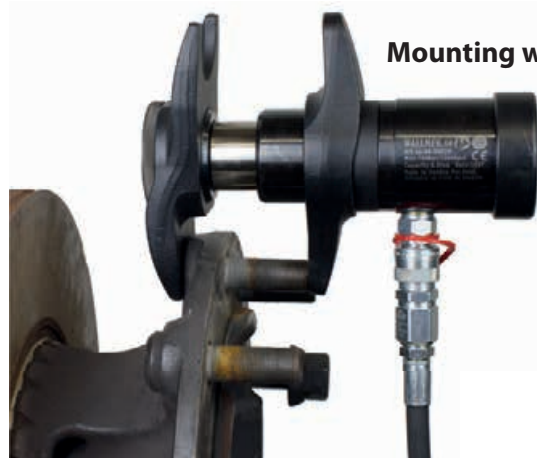

Mounting wheel bolts

Hydraulic cylinders

01-00030 Hydraulic cylinder 18 ton

18 tons pressing and pulling "light weight" hydraulic cylinder in a compact size with automatic return of the piston, only 2,8 kg. Designed for everyday use in auto repair shops.

Can be used with all of our passenger car tools and carriage beams M10-M22 with the proper adaptor.



The cylinder's hydraulic pressure can be combined with punching force when using the punching socket 1086-6. For example when pressing a rusted axle shaft. Weight: 2,8 kg. Stroke: 50 mm.

Automatic return.

Patent Pending European Application No. EP15189415.1

US Patent 10.047.772B2

Parts in the set:

1. 01-00030-001 - Hydraulic cylinder 18 ton
2. Res 4306 - Hydraulic quick coupling
3. Res 4026 - Carriage beam M18/M22, 250mm
4. Res 1090-01-09 - Press plate M24x3
5. Res 4024 - Flange nut M18
6. 1086-6 - Punching socket M22x2,5
7. Res 1090-01-10 - Adjustable press rod 100mm, M24
8. Res 1090-01-12 - Adjustable press rod 132mm, M24
9. 01-00030-005 - Press rod
10. 09-1090-01-11 - Lid for back end



1090-03 Hydraulic cylinder 14 ton

14 tons pressing hydraulic cylinder in a very compact size. Designed for everyday use in auto repair shops. Specially designed to use with press blocks 1090-55-B, 1090-60 and 1090-69. Weight: 2,5 kg. Stroke: 55 mm.

Automatic return.

Parts in the set:

1. 1-1090-03 - Hydraulic cylinder 14 ton
2. RES 1090-01-10 - Adjustable press rod 100mm, M24
3. RES4306 - Hydraulic quick coupling, male

1090-02-WAL Hydraulic cylinder 22 ton

22 tons pressing and pulling hydraulic cylinder in a compact size with automatic return of piston. Designed for everyday use in auto repair shops.



Can be used with all of our passenger car tools and carriage beams M10-M22 with the proper adaptor. The cylinder's hydraulic pressure can be combined with punching force when using the punching socket 1086-6. For example when pressing a rusted axle shaft. Weight: 4,7 kg. Stroke: 70 mm. **Automatic return.**

Parts in the set:

1. 1-1090-02 - Hydraulic cylinder 22 ton
2. 1086-6 - Punching socket M22x2,5
3. RES 1090-01-09 - Press plate M24x3
4. RES 1090-01-10 - Adjustable press rod 100mm, M24
5. 09-1090-01-11 - Lid for cylinder gable
6. RES 1090-02-04 - Press axle 151mm, M24x3
7. RES 1090-05-02 - Adjustable press rod 109mm, M24
8. RES4024 - Flange nut M18
9. RES4026 - Carriage beam M18/M22, 250mm
10. RES4306 - Hydraulic quick coupling, male

03-00015 Hydraulic cylinder 8,5 ton

A very compact cylinder for pressing and pulling. The cylinder comes with an adjustable press rod and a punching socket. This cylinder is very flexible and easy to use also in narrow areas. Specially designed to be used with 03-00014-001 and 03-00005-001. Weight: 1,8 kg. Stroke: 25 mm. **Automatic return.**



Parts in the set:

1. 03-00015-001 - Hydraulcylinder 8,5 ton
2. 03-00015-006 - Punching socket with o-ring
3. 03-00015-012 - Adjustable press rod 100mm, M22 x 2,5
4. RES4305 - Hydraulic quick coupling, male, 1/8"

03-00015-020 Press foot M22

Fit's the press side of the 8,5 Ton hydraulic cylinder 03-00015. The press plate can be used instead of the adjustable press axle delivered with the cylinder.



03-00028 Hydraulic cylinder 32 ton

32 tons pressing and pulling hydraulic cylinder. Designed for everyday use in auto repair shops. Primarily for use with our wheel bearing tools for light commercial vehicles and trucks. Can be used with carriage beams M10-M22 with the proper adaptor. The cylinder's hydraulic pressure can be combined with punching force when using punching socket 1086-6 or punching nut 1091-17-M22. Weight: 8,2 kg. Stroke: 112 mm. **Automatic return.**

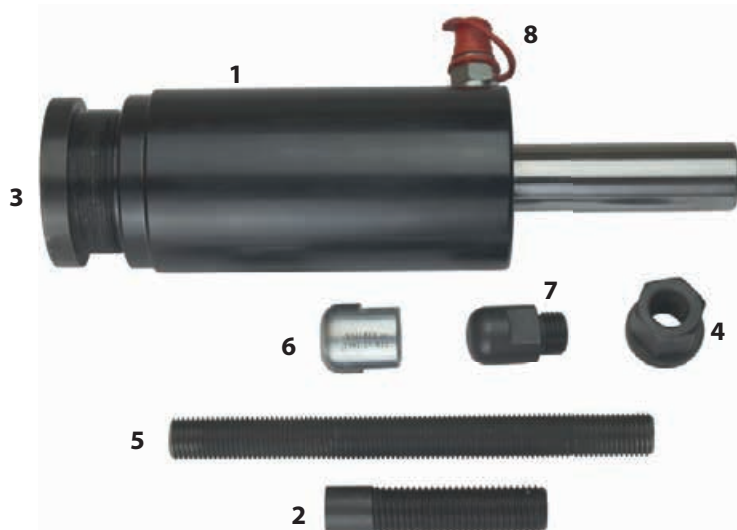

Parts in the set:

1. 03-00028-001 - Hydraulcylinder 32 ton
2. RES 1090-05-02 - Adjustable press rod 109mm, M24
3. RES 1090-05-04 - Thread protection ring (2,5")
4. RES4025 - Flange nut M22
5. RES4027 - Carriage beam M22, 250mm
6. 1091-17 - Punching nut M22
7. 1086-6 - Punching socket M22
8. RES4306 - Hydraulic quick coupling, male

03-00026 Hydraulic cylinder 45 ton

45 ton pressing and pulling cylinder. Designed for everyday use in auto repair shops. Primarily for use with our hub dismantling and King Pin tools 03-00016-45T, 03-00031-45T, 03-00022, 03-00027 etc. The hydraulic cylinder's pressure can be combined with punching force when using punching socket 03-00026-006. Weight: 11,7 kg. Stroke: 70 mm. **Automatic return.**

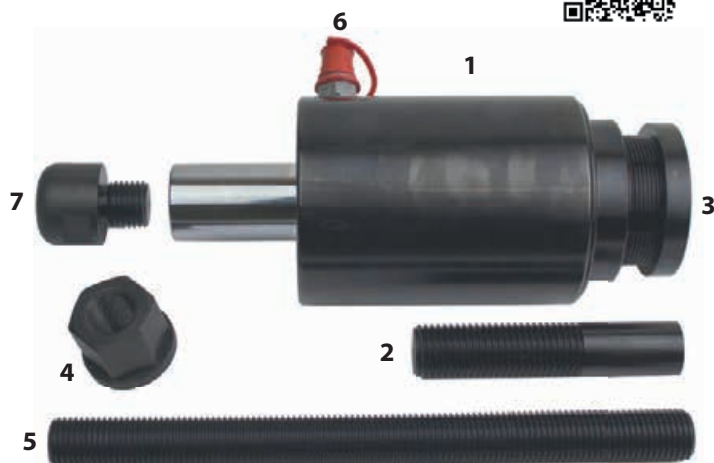

Parts in the set:

1. 03-00026-001 - Hydraulic cylinder 45 ton
2. 03-00026-012 - Adjustable press rod M30.145 mm
3. RES1090-05-04 - Thread protection ring (2,5")
4. RES4035 - Flange nut M27
5. RES4036 - Carriage beam M27. 330 mm
6. RES4306 - Hydraulic quick coupling, male
7. 03-00026-006 - Punching socket M27

01-00031 Punching nut M18

When punching force is needed for pulling with our hydraulic cylinders. Useful for hubs and wheel bearing removal. Also used with the manual carriage beam 01-00020. Depending on hammer size, the extra force is similar as 2,5 – 3,5 times more power than the cylinder power itself.



1086-6 Punching socket M22

To be used on the piston side of the cylinder when pressing out axle shafts e,t,c. The punching socket allows striking by a hammer in the cylinders press direction. Depending on hammer size, the extra force is similar as 2,5 – 3,5 times more power than the cylinder power itself.



RES4031

Carriage beam M22/M24. A specially designed adaptor for pulling out the bolts in digging and lifting arms. The beam can be used with the following cylinders; 01-00030/1090-02-WAL/03-00028.

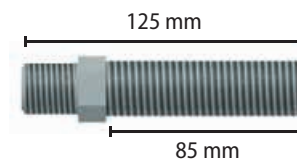

04-00021 Cylinder holder Ø65-100 mm

Developed for use with the following cylinders; 1090-02-WAL, 1090-03 and 03-00028/ 01-00030. The holder is designed for use on the cylinders with hand held use and for use on a floor stand or gear box lift. Adjusting and locking of the cylinder is very easy and flexible for simple use. Also other cylinder brands and types from Ø65 – 100 mm can be mounted in the holder.

Fit's gearbox lift and floor stand with axle measure from 25/30 mm.



1



Parts in the set:

- 04-00021-001 - Holder without clamps
- 04-00021-013 - Clamp Ø70 mm
- 04-00021-014 - Clamp Ø85 mm
- 04-00021-015 - Clamp Ø100 mm

Use with cylinder:

- 1090-01 (16 T)
- 1090-02 (22 T)
- 1090-03 (14 T)
- 03-00028 (32 T)
- 01-00030 (18 T)



Hand held



Gearbox lift and floor stand

Adaptors for other tool systems

1. **1068-04** Adaptor 1 ½" to 2 ¼" – 14UNS (Klann thread)
2. **1068-05** Adaptor 1 ½" to G2 ½" – 11 (16 and 22 ton cylinder - 32 tons cylinder thread)
3. **1068-06** Adaptor 2 ¼" – 14UNS (Klann thread) to 1 ½"
4. **1068-07** Adaptor 1 ½" to M55x1,5 (Volvo thread)
5. **1068-08** Adaptor 1 ½" to M68x2 (Paschke thread)
6. **1068-09** Adaptor M68x2 (Paschke thread) to 1 ½"
7. **1068-10** Adaptor 2 ¾" – 16UNS G2 ½" (Klann thread) to 2 ½"
8. **1068-11** Adaptor 2 ¾" – 16UNS G1 ½" (Klann thread) to 1 ½"



1090-32 Carriage beam, flange nut & adaptor set

Set of carriage beams, flange nuts and adaptors.

Parts in the set:

1090-32-10

RES4014

Carriage beam M10, 150 mm in 12.9 quality.



RES4012

Adaptor M22 → M10



RES4023

Flange nut M10

1090-32-12

RES4015

Carriage beam M12, 250 mm in 12.9 quality.



RES4011

Adaptor M22 → M12



RES4022

Flange nut M12

1090-32-14

RES4016

Carriage beam M14, 250 mm in 12.9 quality.



RES4010

Adaptor M22 → M14



RES4021

Flange nut M14

1090-32-18

RES4026

Carriage beam M18/M22, 250mm in 12.9 quality.



RES4024

Flange nut M18

1090-32-22

RES4027

Carriage beam M22, 250mm in 12.9 quality.



RES4025

Flange nut M22



RES4036

Carriage beam M27, 330 mm in 10.9 quality.



RES4035

Flange nut M27



RES4037

Carriage beam M27, 500 mm in 10.9 quality.



RES4008

Adaptor M27 → M24



RES4039

Adaptor M27 → M22



RES4009

Adaptor M22 → M18

04-00008-001 Carriage beam M10, 1000 mm

Produced in 12:9 quality, can also be ordered in ½ (delivered then in 500 mm length)

04-00008-002 Carriage beam M12, 1000 mm

Produced in 12:9 quality, can also be ordered in ½ (delivered then in 500 mm length)

04-00008-003 Carriage beam M14, 1000 mm

Produced in 12:9 quality, can also be ordered in ½ (delivered then in 500 mm length)

04-00008-004 Carriage beam M22, 1000 mm

Produced in 12:9 quality, can also be ordered in ½ (RES4034) (delivered then in 500 mm length)

04-00008-005 Carriage beam M18, 1000 mm

Produced in 12:9 quality, can also be ordered in ½ (delivered then in 500 mm length)

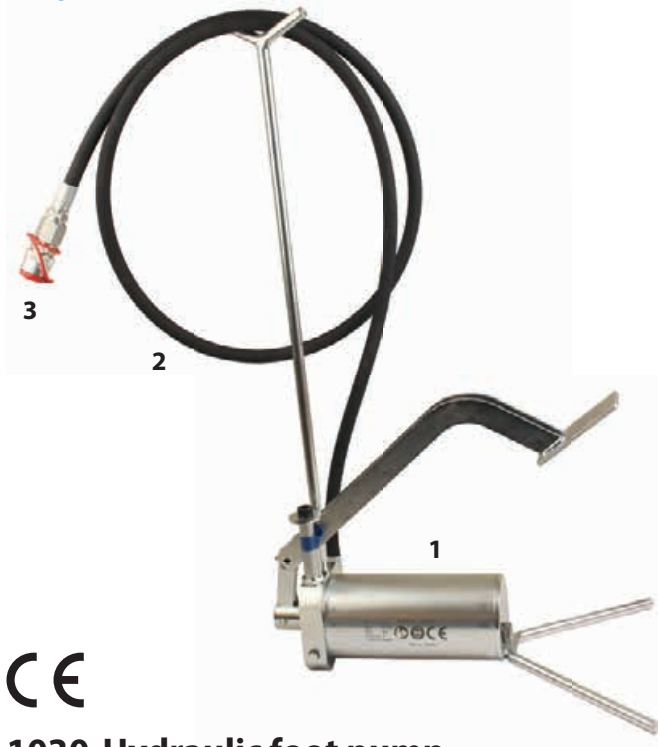

1030 Hydraulic foot pump

Hydraulic foot pump 700 bar for use with all of our hydraulic cylinders. 2,2 m hose and drip-free quick coupling. Oil tank volume 0,75 litres.

Parts in the set:

1. 1-1030 - Hydraulic foot pump
2. RES 1030-02 - Hydraulic hose for 1030, 1035 & 1036
3. RES4304 - Hydraulic quick coupling, female



1036 Pneumatic, variable hydraulic pump



Pneumatic driven hydraulic pump with variable speed for better control. Max pressure 700 bar for use with all of our hydraulic cylinders. The pump is delivered with a pressure gauge next to the pedal and 2,2 m hose and drip-free quick coupling. Oil tank volume 1,3 litres.

Parts in the set:

1. 1-1036 - Pneumatic, variable hydraulic pump
2. RES 1030-02 - Hydraulic hose for 1030, 1035 & 1036
3. RES4304 - Hydraulic quick coupling, female



04-00020 Hydraulic oil 1 L

High quality hydraulic oil, optimal for Wallmek's hydraulic tools and pumps. Regular hydraulic oil change and correct volume increases the operation time of the components.



04-00016 Pressure gauge set for hydraulic pumps 1030 and 1035

A complete kit with coupling and nipple for connection directly to any Wallmek hydraulic pumps. The hydraulic cylinders manual includes a chart that shows the maximum oil pressure in bars for each different carriage beam.



04-00015 Safety cover with catch strap

Additional item for hydraulic operation directly on the car. Prevents damage if parts brakes or falls down.

INVEST IN TIME



After a few years on the road it's a time consuming effort to dismount most parts that's been exposed to water, salt and wear. With the right design and function of the tool system there are many hours to be saved every day when working under the vehicle.

The Wallmek tool system gives the shop the possibility to work more efficient and easier. The basic parts in the tool system are used for many different models and type of jobs, this makes the investment even more obvious, economical and efficient.

The right tools in not a cost, it's the best investment in the technician's potential to get the job done quicker and safer. The expensive tool is the one that doesn't get the job done at all or break due to bad quality when you need it the most.

Today's shops want skilled and experienced technicians that doesn't get injured due to his job. Ergonomics and working environment are the basic things that makes it possible to keep the best technicians in the shop, loving what they do. The shop will then increase the productivity and the skill level gets higher every day.

03-00031-32T/45T Universal set for Kingpin

This set is designed to cover most Kingpins on the market, also the conical types. It's used with 32/45 ton hydraulic cylinder designed with punching capability. This function makes it possible to hammer on the cylinder (with punch adaptor fitted) during maximum pressure. The combination of high pressure and vibrations are very efficient and often crucial for a successful result.

With this tool, heating or heavy lifting in the shop press is no longer needed. The compact design makes it possible to do the job also on buses where the access normally is limited.

The set is used with the brand specific sets add on kits that also are available.

Protected Design within EU - RCD No. 003068006-0001/0002



Parts in the set 03-00031-32T:

1. 03-00031-001 Press block
2. 03-00006-027 Press pipe
3. 03-00006-028 Adaptor plate
4. 03-00006-030 Press socket
5. 03-00006-006 Press pipe 130 mm
6. 03-00006-029 Press pipe 85 mm
7. 03-00006-007 Press pipe 42 mm
8. 03-00006-020 Press axel 50 mm Ø31mm
9. 03-00006-002 Press axel 140 mm Ø31 mm
10. 03-00006-001 Press axel 250 mm Ø31 mm

Parts in the set 03-00031-45T:

1. 03-00031-001 Press block
2. 03-00006-027 Press pipe
3. 03-00006-028 Adaptor plate
4. 03-00006-030 Press socket
5. 03-00006-006 Press pipe 130 mm
6. 03-00006-029 Press pipe 85 mm
7. 03-00006-007 Press pipe 42 mm
8. 03-00032-001 Press axel M30, L=30, Ø=38 mm
9. 03-00032-002 Press axel M30, L=140, Ø=38 mm
10. 03-00032-003 Press axel L=50, Ø=38 mm
11. 03-00032-004 Press axel L=70, Ø=38 mm
12. 03-00032-005 Press axel L=100, Ø=38 mm



03-00031-200 Add on set for BPW and SAF king-pin

The set are used with 03-00031-32T or 45T (45T recommended).

With the set it's possible to dismount and mount the king-pin directly on the trailer axle.

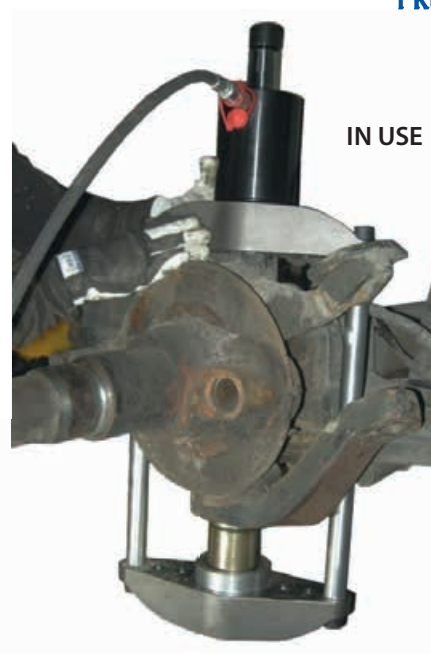

Parts in the set:

1. 2 pcs 03-00031-201 - Support rod
2. 03-00031-202 - Extender
3. 03-00031-203 - Extender
4. 3 pcs 03-00031-204 - Extender
5. 03-00031-205 - Press plate
6. 03-00031-206 - Pressplate



03-00006-022 Press ring collar Volvo Kingpin

Is used with universal set 03-00031 for mounting the lower bearing on Volvo kingpins with locknuts underneath.



03-00006-023 Mounting plate Volvo Kingpin

Is used with universal set 03-00031 for pressing in Volvo kingpins with locknuts underneath. The plate guides the kingpin into position when pressing/mounting.



03-00006-024 Press socket Scania Kingpin

Is used with universal set 03-00031 for pressing out Scania conical kingpins.



03-00031-220 Add on set for Mercedes Actros and Atego king-pin

The set are used with 03-00031-32T or 45T (45T recommended).

With the set it's possible to dismount and mount the king-pin directly on the truck axle.

Parts in the set:

1. 03-00032-101 - Press axle M30. L=137 mm. Ø 29 mm
2. 03-00031-221 - Guide socket
3. 03-00006-022 - Dismounting collar Volvo Kingpin
4. 03-00031-204 - Extender
5. 03-00031-203 - Extender
6. 03-00031-303 - Guide socket

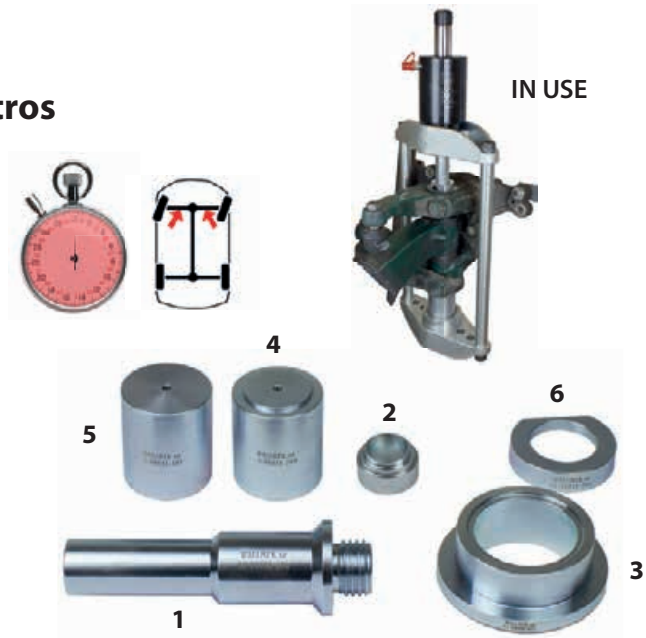

03-00031-300 Add on set for MAN TGA, TGX and TGS king-pin

The set are used with 03-00031-32T or 45T (45T recommended).

With the set it's possible to dismount and mount the king-pin directly on the truck axle.

Parts in the set:

1. 03-00031-302 – Press pipe
2. 03-00031-303 - Guide ring
3. 03-00031-203 - Extender
4. 03-00031-204 (x2) - Extender



03-00020-32T / 03-00020-45T Wheel bearing set (Unit) Scania

With this set a wheel bearing is replaced quick and easy directly at the vehicle, no need to go to the shop press. The set is used with hydraulic cylinder 03-00028 32T/45T or 03-00026 and hub puller set 03-00016-32T/45T. Parts for allowing hammer punching during max pressure are also included.

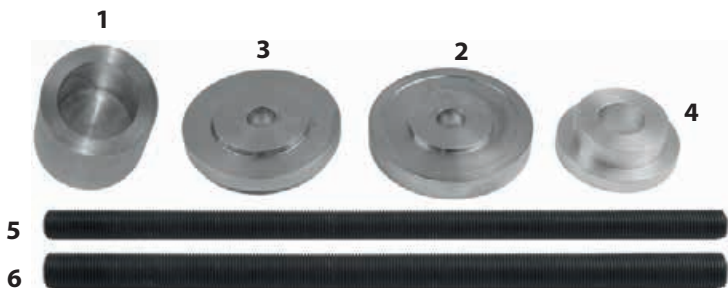

Parts in the set:

03-00020-32T

1. 03-00006-026 Press socket 65 mm
2. 03-00020-001 Press plate Scania unitlager
3. 03-00020-002 Press plate Scania unitlager
4. 03-00020-003 Protection socket Scania unitlager
5. RES4034 Carriage beam M22, 500 mm

Parts in the set:

03-00020-45T

1. 03-00006-026 Press socket 65 mm
2. 03-00020-001 Press plate Scania unitlager
3. 03-00020-002 Press plate Scania unitlager
4. 03-00020-003 Protection socket Scania unitlager
6. RES4034 Carriage beam M27, 500 mm

03-00008-32T / 03-00008-45T Spring bolt set (Scania)

A tool set for quick dismantling of the spring bushing bolts. The job is done directly on the truck with a minimum of part dismantling.

The set is used with the threaded plate 03-00031-002 from the press block 03-00003-001 (none of these are included), also designed for punching. The combination of the high pressure and vibrations are very efficient and often crucial for a successful result when pressing out the rusted bolt.

The set is used with hydraulic cylinder 03-00028 (32 ton) or 03-00026 (45 ton).

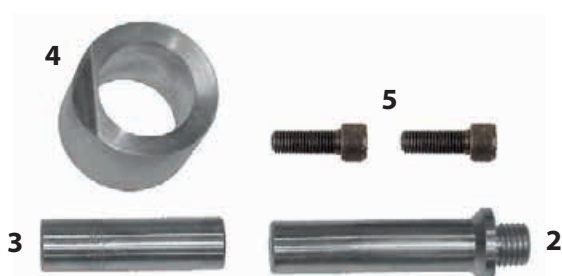

Parts in the set:

03-00008-32T

1. 03-00004-001 - Press block
2. 03-00006-009 - Press axle 115 mm Ø29 m
3. 03-00006-010 - Press axle 100 mm Ø29 mm
4. 03-00006-011 - Press pipe 60 mm Ø54 mm
5. 2 pcs 03-00003-005 - Screw M22x60 12.9 hex



Parts in the set:

03-00008-45T

1. 03-00004-001 - Press block
2. 2 pcs 03-00032-102 - Press axle L=64 mm. Ø=29 mm
3. 03-00032-101 - Press axle M30. L=137 mm. Ø 29 mm
4. 03-00006-011 - Press pipe 60 mm Ø54 mm
5. 2 pcs 03-00003-005 - Screw M22x60 12.9 hex



03-00031-002 Plate with thread for press block (not included)

Included in universal set 03-000031-32T/45T.

Protected Design within EU - RCD No. 003068006-0002

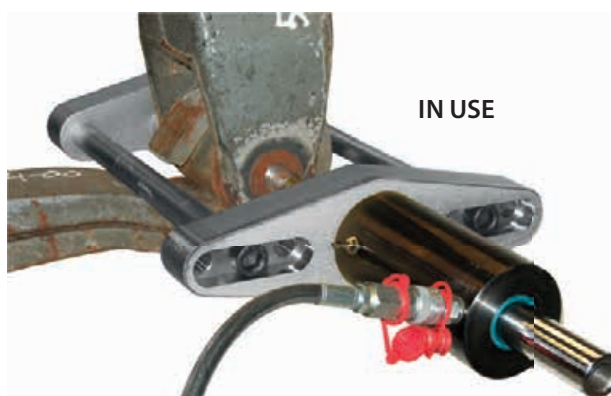

03-00040-001 Adaptor M22 – M30

The adaptor makes it possible to pull out M30 bushing bolts with the 32 Ton cylinder 03-00028. An appropriate press pipe is used in combination with the adaptor when pulling.



03-00023 U Joint tool

Basic tool for quick and easy replacement of U-joints on trucks and buses. The job is done directly on the vehicle instead of heavy lifting and handling in the garage press. No need to send away these jobs. The tool saves a lot of time and improves the working environment. Adaptor set are ordered separately. Used with 8,5 ton cylinder 03-00015 (not included).



IN USE

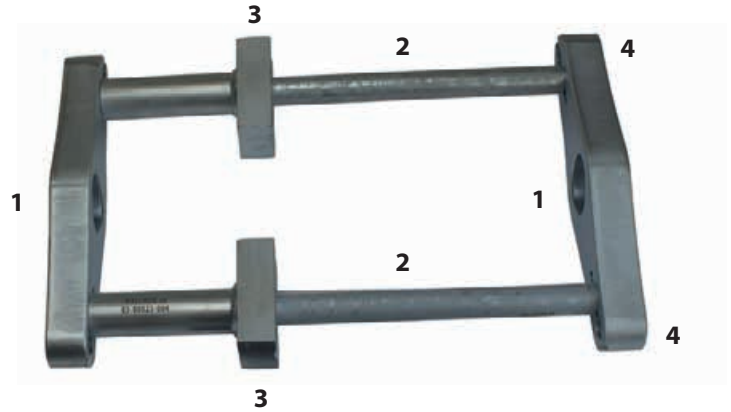

Parts in the set:

1. 2 pcs 03-00023-002 - Plate
2. 2 pcs 03-00023-003 - Rod
3. 2 pcs 03-00023-004 - Anvil
4. 4 pcs 1090-60-04 - Bolt M16x40



03-00023-050 Adaptor set for Scania U Joints

This set is designed to fit all Scania U joints and axels; 300, 400, 500 and 600. The job can be done with the axle partly still mounted on the vehicle. The set is used with the basic tool 03-00023 and 8,5T cylinder 03-00015.

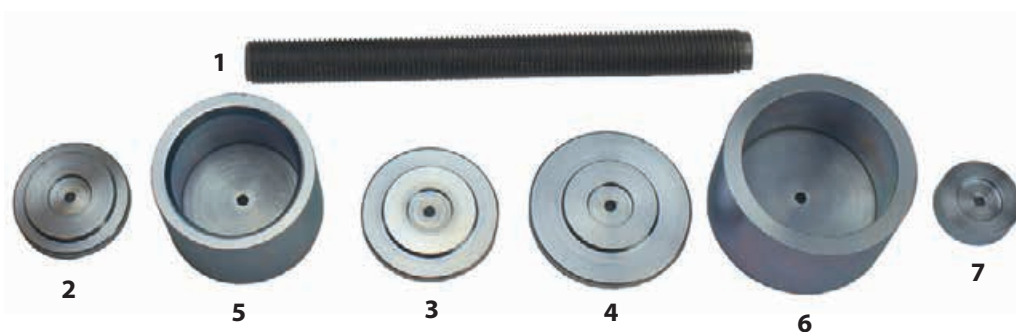

Parts in the set:

1. 03-00023-005 - Press axel
2. 03-00023-006 - Plate Ø47 mm
3. 03-00023-007 - Plate Ø55 mm
4. 03-00023-008 - Plate Ø65 mm
5. 03-00023-009 - Socket Ø58 mm
6. 03-00023-010 - Socket Ø68 mm
7. 03-00023-013 - Plate Ø37 mm
8. 03-00023-014 - Set of spacers



03-00025 Dismantling set, Volvo/Renault/DAF floating brake disc

A brand new tool that really helps when Volvo's floating brake discs need to be removed. The disc brake is pressed out one cylinder at a time. This is very efficient and saves a great deal of time in the workshop. Pressing at extreme pressure using a workshop press on sensitive metal parts or cutting off the thick brake disc are both noisy and dangerous operations.

The tool consists of two special cylinders and a control valve for crosswise pressing. Pressing out the disc in this way only takes a few minutes. Used with 1030 and 1036.



03-00034 Hydraulic cylinder 14 ton with hose and coupling

The compact cylinder makes it possible to separate parts also in tight areas where normal cylinders won't fit. This type of jobs is made in any automotive garage, industry or maintains shop.

NEW!

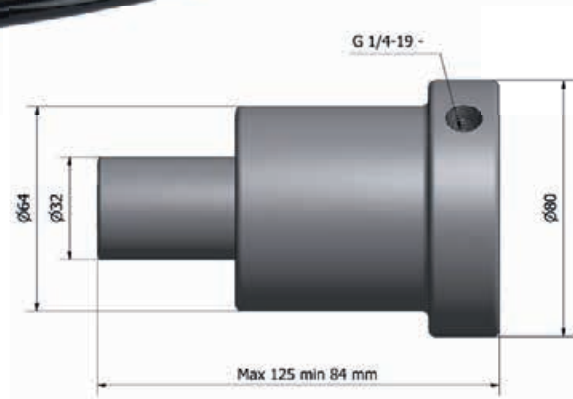

Parts in the set:

- 1. 3-00019 - Hydraulic press cylinder 14T
- 2. 03-00019-010 - Hose 0,5 m
- 3. Res 4306 - Cejn nippel hydraulic male 1/4"

Max pressure	700 bar	Stroke	41 mm
Force	14 ton	Hose length	0,5 m
Weight	2,3 kg		

03-00035 Universal puller for transmission flange on propeller shaft

Puller for transmission flanges on prop shafts and gearboxes.

When the propeller shaft bearing needs to be replaced the flange needs to be dismantled. It's used with an 18 tons hydraulic cylinder 01-00030 (not included). The complete job is made on the vehicle without time consuming and heavy lifting in the garage press.

The tool is designed for maximal adjustment and flexibility for fitting on any truck or bus axle flange. Gear boxes with retarder or other applications are also possible to fit with this tool due to its design.

Rec. cylinder 01-00030.

Protected Design within EU - RCD No. 003477090-0001/0002
Patent Pending - European Patent Application No. EP16200076.4
US Design Patent Pending - US Patent Application No. 29/604 325
Patent Pending - European Patent Application No. EP16200070.7

Parts in the set:

1. 2 pcs 03-00035-001 - Press foot
2. 01-00041-002 - Fixing plate 1 1/2" thread
3. 2 pcs 01-00041-003 - Sliding plate
4. 2 pcs 01-00018-004 - Screw
5. 4 pcs 01-00041-005 - Screw M14x45 10.9, hex
6. 03-00035-002 - Bolt set M12, hex. 4 pc
7. 03-00035-005 - Adjustable press rod M24

NEW!

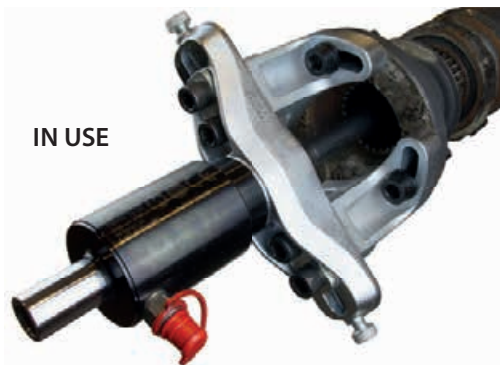

IN USE



03-00035-201 Thread adaptor Scania M44x1,5 – M22x2,5

The adaptor makes mounting of the bearing and flange a simple operation. Use a M22 rod for mounting manually or with hydraulic cylinder.



03-00035-101 Press rod Volvo FL, M20

Protects the inner thread on the axle and makes dismantling of the flange easier.



NEW!

03-00036 Universal puller for prop axle/shaft bearing and pitman arm

Adjustable and universal to cover most prop axle bearings and pitman arms. Used with a 18 ton hydraulic cylinder 01-00030 (not included). The adjustable press feet's are wedge shaped for better acces.

After many years on the road in exposed positions most parts get rusted and stuck. Standard or manual tools are normally not strong enough to do the job. With the help from the 18 ton hydraulic cylinder with hammer function the job is made easy with a minimum of wear. Heavy and risky jobs in the shop press are also minimized with the tool.

Rec. cylinder 01-00030.

Patent Pending - European Patent Application No. EP15194783.5
Protected Design within EU - RCD No. 003477090-0001/0002
Patent Pending - European Patent Application No. EP16200076.4
US Design Patent Pending - US Patent Application No. 29/604 325

- Parts in the set:**
- 1. 2 pcs 03-00036-001 - Press foot
 - 3. 01-00041-002 Fixing plate 1 ½" thread
 - 4. 2 pcs 01-00041-003 - Sliding plate
 - 5. 2 pcs 01-00018-004 - Screw
 - 6. 4 pcs 01-00041-005 - Screw M14×45 10.9, hex

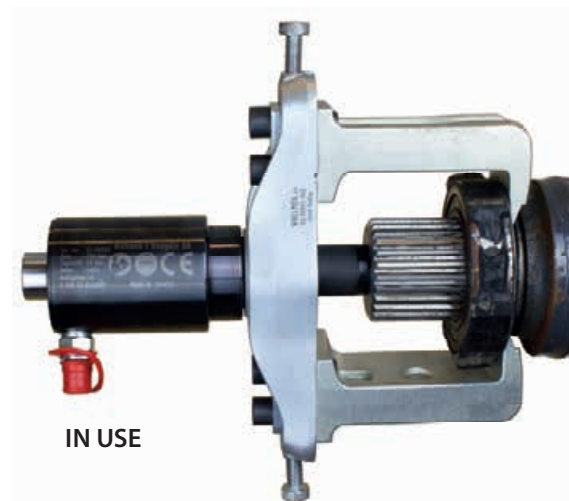
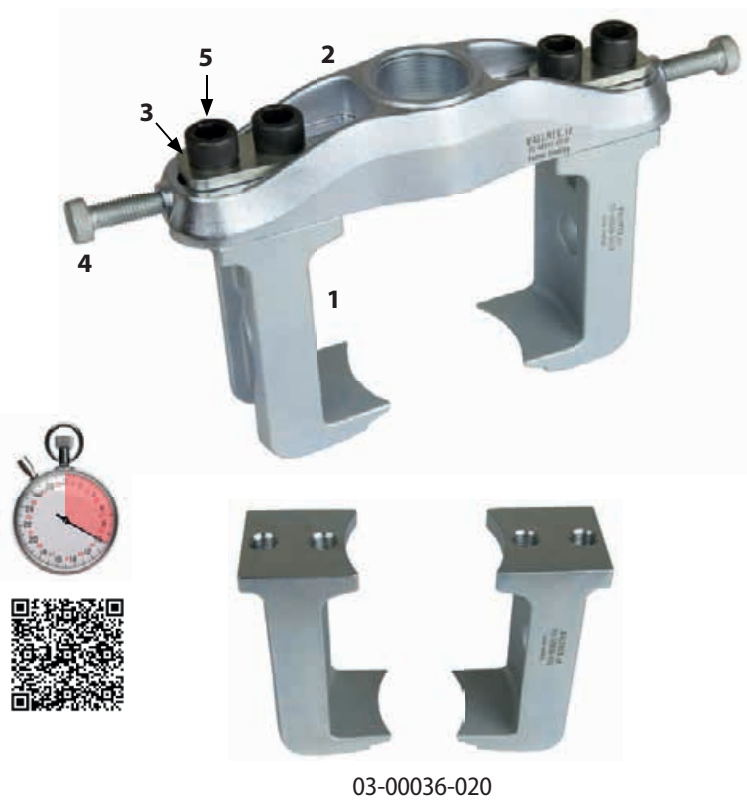

03-00035-300 Set with 03-00035 and 03-00036-020

For efficient dismounting of flanges and supporting bearing on propeller shafts and dismounting of pitman arms on steering gears.

The set are delivered in a foam for practical storage.

Only foam; 04-00022-016.



03-00030 Hydraulic ball joint puller

Press clamp for dismantling steering joints on trucks/buses and ball-joints on light commercial vehicles. See also 04-00028 page 1.

The clamp is special designed to fit on most steering axles and ball-joints on light commercial, vehicles, heavy trucks and buses on the market. Moulded with special steel to withstand greater force.

Parts in the set:

1. 03-00014-001 – Steering joint puller
2. 03-00015 – Hydraulic cylinder 8,5 ton



03-00016-32T/03-00016-45T Bolt pattern 8/275, 10/335

The tool is flexible and fits heavy trucks/buses and trailers with 8 bolt 275 mm and 10 bolt 335 mm. Chose set depending on the cylinder size in use. The plate with thread is also used as part in the press block 03-00031-001.

Protected Design within
EU - RCD No. 003068006-0002

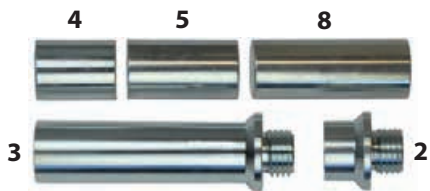
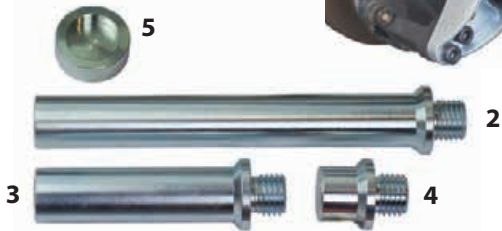

03-00016-32T The tool is used with 32 tons hydraulic cylinder 1090-05/03-00028. The robust design allows also punching with a hammer on the cylinder during max press. This function makes it possible to press out hubs also with unit wheel bearings from straight axles.

Parts in the set:

1. 2 pc 03-00016-001 – Press foot for hub puller
2. 03-00006-001 – Press axle 250 mm Ø31mm
3. 03-00006-002 – Press axle 140 mm Ø31mm
4. 03-00006-020 – Press axle 50 mm Ø31mm
5. 03-00006-021 – Press plate
6. 03-00031-002 – Plate with thread
7. 4 pc 03-00003-005 – Screw M22×60 12.9, hex socket

03-00016-45T The tool is used with 45 tons hydraulic cylinder 03-00026. The robust design allows also punching with a hammer on the cylinder during max press. This function makes it possible to press out hubs also with unit wheel bearings from straight axles.

Parts in the set:

1. 2 pc 03-00016-001 – Press foot for hub puller
2. 03-00032-001 – Press axle 30mm Ø38mm
3. 03-00032-002 – Press axle 140 mm Ø38mm
4. 03-00032-003 – Extender 50 mm Ø38mm
5. 03-00032-004 – Extender 70 mm Ø38mm
6. 03-00031-002 – Plate with thread
7. 4 pc 03-00003-005 – Screw M22×60 12.9, Hex socket
8. 03-00032-005 – Extender 100 mm Ø38mm



03-00006-025 Extender for hub puller

For use with hub puller 03-00016-32T/-45T on axels with hub reduction/gear inside the hub (4 pcs needed). M22, 50 mm. For example Scania.

03-00022 Hub puller for low loader trailers with 10/225 hubs

Extension set to 03-00016 for removal of 225 mm hubs and 10 bolts, hydraulic cylinder 03-00028 (32 ton) and 03-00026 (45 ton) is used with the set. The heavy-duty design supports a full 45 ton pressure and hammer strokes in the direction of pressure (on the cylinder) during removal. This makes it also possible to remove hubs with unit bearings on straight axles.

Parts in the set:

1. 2 x 03-00022-001 - Plate
2. 4 x 03-00022-002 - Arm
3. 03-00022-003 - Thrust washer SAF Ø 73 mm
4. 8 x 03-00003-005 - Screws M22x60 12.9.



03-00031-002 Plate with thread for press block (not included)

Included in universal set 03-00031-32T/45T.
Protected Design within EU - RCD No. 003068006-0002

IN USE

03-00016-011 Press plate SAF 110/88 mm

The press plate is designed for hollow wheel axles and are used when pressing hub/bearing off from the axle with hub puller set 03-00016. The plate is designed to fit the accessible surfaces and also withstand the power needed for dismounting the hub from the axle.



NEW!

03-00027-32T / 03-00027-45T Puller set with pressure rod for hubs without wheel bolts

The set makes it possible to efficiently remove rusted bearings with external hubs from straight axles. Developed for Volvo FL, MAN TGA, TGS, TGX, Mercedes Atego, Actros, Renault Kerax, Magnum, Midlum and Premium, fits also other brands with the same bolt dia. The set is used with hydraulic cylinder 03-00028 (32 ton) or 03-00026 (45 ton).



Parts in the set:

03-00027-32T

1. 03-00027-010 - Plate
2. 03-00027-012 - Adaptor M82x2-G2 ½"-11
3. 03-00027-002 (M24) - Press rod

03-00027-45T

1. 03-00027-010 - Plate
2. 03-00027-012 - Threaded pipe
4. 03-00027-003 (M30) - Press rod

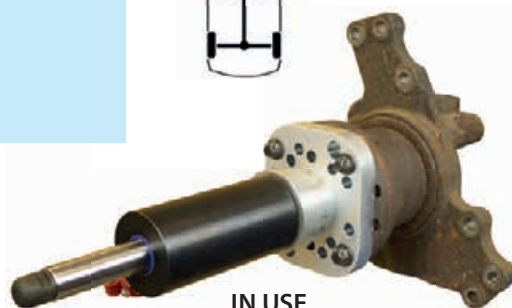

IN USE

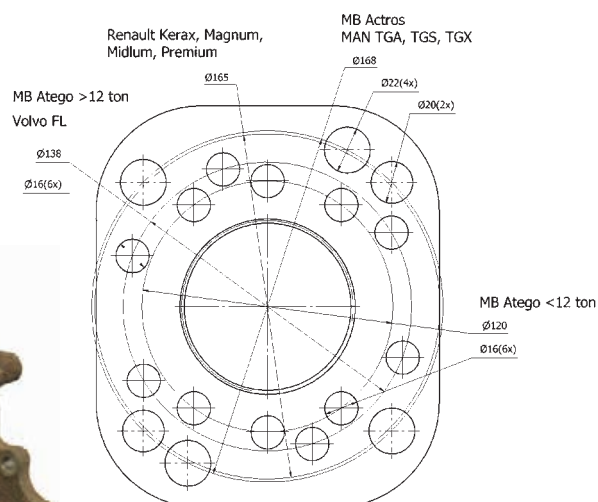

NEW!

03-00037 Mounting tool for slotted bushings

The clamp in this set is used in combination with the different adaptors for compressing slotted bushings on trucks and buses. A vise is used to easily compress the bushings, a lock pin are then tapped in and locks the clamp during mounting of the bushing. No fragile bolts or threads to be used with this system!
The set fits the following sizes; 95 mm, 85 mm, 80 mm, 75 mm, 70 mm and 65 mm.

This set are used with bushing set 03-00038 that includes de-mount and mounting plates and pipes in proper dimensions.

Parts in the set:

- 1. 03-00037-001 Clamp Ø95 mm
- 2. 2 pcs 03-00037-011 - Adaptor Ø65 mm
- 3. 2 pcs 03-00037-012 - Adaptor Ø70 mm
- 4. 2 pcs 03-00037-013 - Adaptor Ø75 mm
- 5. 2 pcs 03-00037-014 - Adaptor Ø80 mm
- 6. 2 pcs 03-00037-015 - Adaptor Ø85 mm

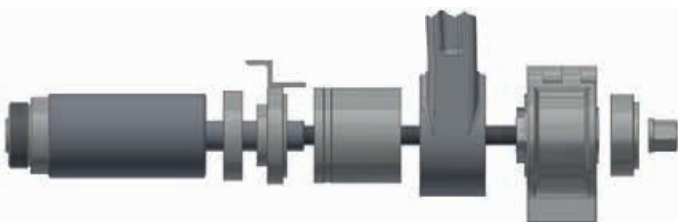

IN USE

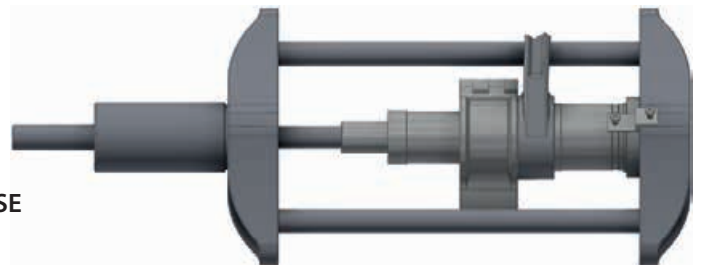

03-00037-209 Adapter set Ø60 mm bussing

A set with two adaptor half's 03-00037-009 for compressing of 60 mm truck bushings. Is used with the clamp in set 03-00037.



03-00038 Bushing set with fixing plate

The combination of sizes on the press pipes and press plates makes the set very useful on commercial vehicles, ether directly on the chassis or in the shop press.
The fixing plate in the set makes it possible to fixate the press pipes on to the bottom of the press block.
This makes it the job easier, less parts needs to be centered in positon by hand during mounting or demounting.

The set can be complemented with 03-00037 to get a complete solution for slotted bushings.

The set can be used with the press block 03-00031-001 or a 32 tons hydraulic cylinder 03-00028. Adaptor for the cylinder are included in the set.

NEW!



Parts in the set:

1. 03-00038-028 - Press pipe, A 110mm, B107mm, C96mm, D100mm
2. 03-00038-027 - Press pipe, A 93,5mm, B 91,5mm, C 88,5mm, D100mm
3. 03-00038-026 - Press pipe, A 89,5mm, B 87mm, C 73mm, D 100mm
4. 03-00038-025 - Press pipe, A 84.5mm, B 82mm, C 72mm, D 100mm
5. 03-00038-024 - Press pipe, A 79,5mm, B 77mm, C 67mm, D 100mm
6. 03-00038-023 - Press pipe, A 74,5mm, B 72mm, C 62mm, D 100mm
7. 03-00038-022 - Press pipe, A 69,5mm, B 67mm, C 57mm, D 100mm
8. 03-00038-021 - Press pipe, A 64,5mm, B 62mm, C 52mm, D 100mm
9. 03-00038-011 - Press plate, A 64,5mm, B 52,5mm, C 51,2mm, D 32mm
10. 03-00038-012 - Press plate, A 69,5mm, B 57,5mm, C 56,2mm, D 32mm
11. 03-00038-013 - Press plate, A 74,5mm, B 62,5mm, C 61,2mm, D 32mm
12. 03-00038-014 - Press plate, A 79,5mm, B 67,5mm, C 66,2mm, D 32mm
13. 03-00038-015 - Press plate, A 84,5mm, B 72,5mm, C 71,2mm, D 32mm
14. 03-00038-016 - Press plate, A 89,5mm, B 77,5mm, C 72,2mm, D 32mm
15. 03-00038-017 - Press plate, A 93,5mm, B 81,5mm, C 76,7mm, D 32mm
16. 03-00038-001 - Press adaptor 30mm
17. 03-00038-002 - Press adaptor 86mm
18. 03-00038-003 - Cylinder adaptor (for 32 T)
19. 03-00038-004 - Fixing plate

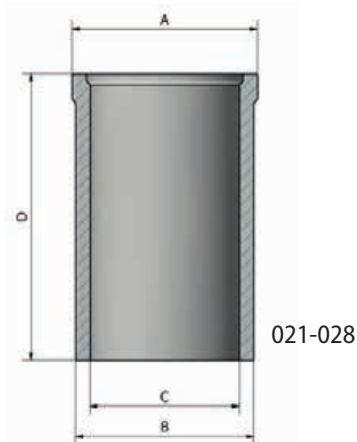
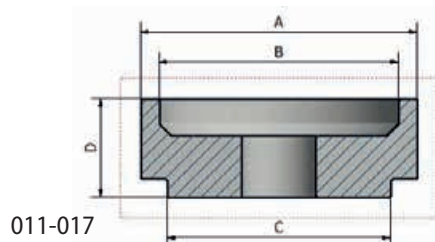

04-00025 Adjustable press block holder

The holder makes it possible to work in any angle with the press block 03-00031-001 with a cylinder mounted in it. A gear box lift or similar with wide wheel base can be used for the holder. The diameter of the inner hole is 25 and 30 mm.

The many positions on the flange in combination with the swiveled head maximize the access under the vehicle.

The holder is developed to be used with bushing set 03-00037 and 03-00038.

Fit directly on the press block 03-00031-001.



NEW!

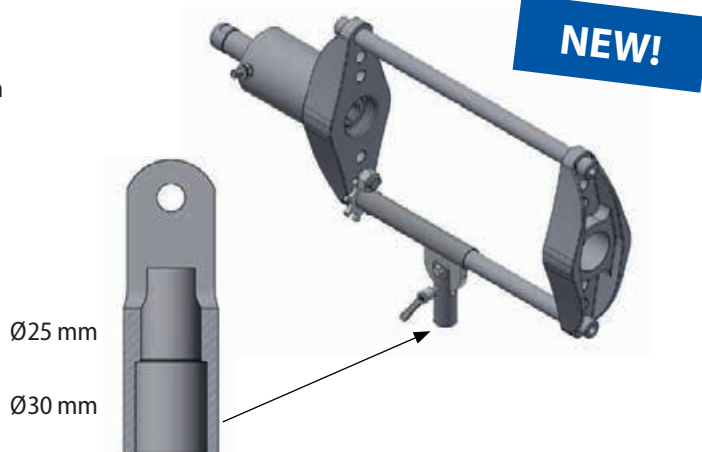

03-00009 Spring bushing set, universal

The spring and shackle bracket bushings (44–64 mm) are quick and easy replaced. No heating or lifting in the shop press is needed when working with this set. It's used with the 32 ton cylinder 03-00028 (not included).

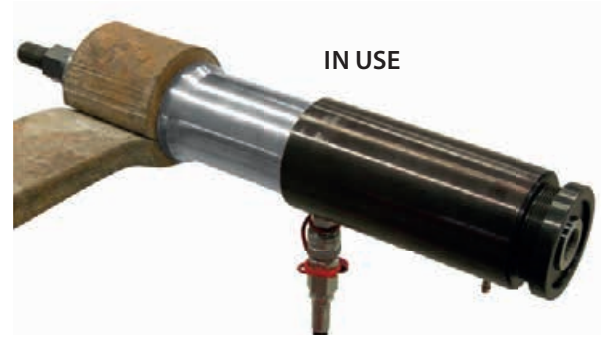

Parts in the set:

1. 03-00006-006 – Press pipe 130 mm
2. 03-00006-007 – Press pipe 42 mm
3. 03-00006-014 – Press plate Ø63 mm
4. 03-00006-015 – Press plate Ø50 mm
5. 03-00006-016 – Press plate Ø44 mm
6. 03-00006-017 – Press plate Ø63 mm
7. 03-00006-018 – Press plate Ø57 mm
8. RES4024 – Flange nut M18
9. RES4026 – Carriage beam M18/M22, 250 mm



03-00013 Bushing set SAF-axle, 150 mm

A set for quick and easy replacement of the large 150 mm bushing in SAF, MB, Jost and ROR axles. The set is used with the 32 ton hydraulic cylinder 03-00028 (not included).

Parts in the set:

1. 03-00013-001 – Mounting ring 45 mm
2. 03-00013-002 – De/mounting ring 20 mm
3. 03-00013-003 – De/mounting plate
4. 1091-17-02 – Press plate
5. 1091-17-03 – Press pipe
6. RES4034 – Carriage beam M22, 500 mm

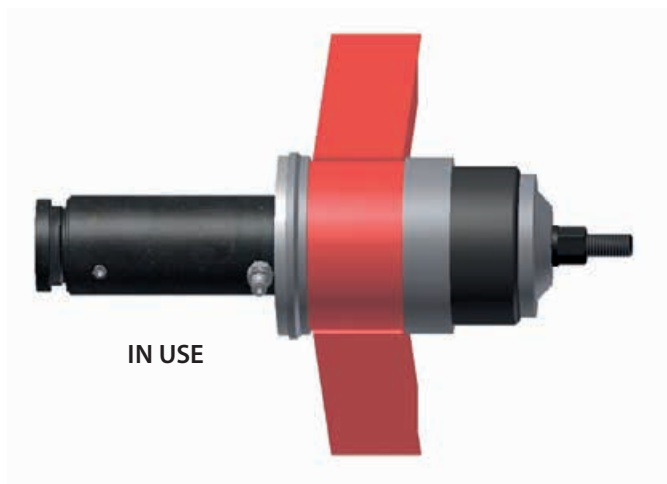
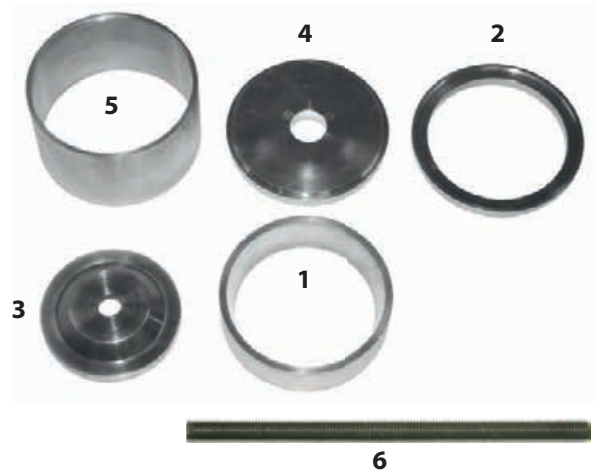

03-00010 Bushing set for VBG drawbars

This set is primarily designed for VBG bushings and drawbars but is also universal. The bushing is replaced with 32 ton hydraulic cylinder 03-00028 (not included) with the unique punching function directly on the drawbar. The bushing is replaced quickly with no need of heating.



Parts in the set:

1. 03-00006-006 – Press pipe 130 mm
2. 03-00006-007 – Press pipe 42 mm
3. 03-00006-013 – Press plate Ø59 mm



03-00006-012 Adaptor for VBG drawbar bolts

The adaptor is used with the Kingpin set 03-00031 for pressing out the bushing bolts on VBG drawbars (not hex bolts). The bolt is pressed out in a similar way as the kingpin but with the press frame in a horizontal position.



03-00017 Press block set for pulling out truck/trailer connectors with VBG 55 mm axle



With this set the complete pulling connector is pulled out from its holder when maintenance is needed. This solution saves a lot of time and efforts during dismounting. It is used with one of the following cylinders; 1090-02 or 01-00030.



03-00005-001 Automatic brake adjuster puller/steering joint on trailers

Used for pressing out rusted and stuck axles from the brake adjuster. Fits most types on the market from Haldex and BPW. See also 04-00028, page 1. The tool is used with a 8,5 ton hydraulic cylinder 03-00015 (not included). The design allows good access even in narrow areas on the vehicle.



04-00030 Air hammer for tie rod ends

The air hammer is developed for efficient work on tie rod ends on trucks and buses, replacing or only adjustment. Vibrations in combination with rust dissolving liquid make the threads adjustable again.

This version is reinforced and improved for daily use in shop environment. 3000 rpm, vibration damped handle and bracket for better ergonomomi.

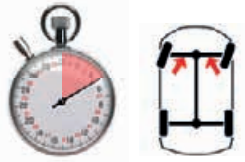

04-00031 Fixed wrench 34 mm

Power full and slip free wrench for tie rod ends with 34 mm 6 point grip. The wrench is used in combination with the air hammer 04-00030 for adjusting or replacing the tie rod ends on truck and buses.

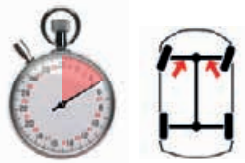

04-00018 Adaptor set for Popnut 6, 8, 10 and 12 mm

With the power from hydraulic cylinder 03-00015 8,5 ton (not included) the popnuts are mounted quick and easy also in narrow position. The set is delivered with carriage beams and adaptors for 6, 8, 10 and 12 mm Popnut. The cylinder is used with a 700 bars hydraulic pump 1030 or 1036 (not included).

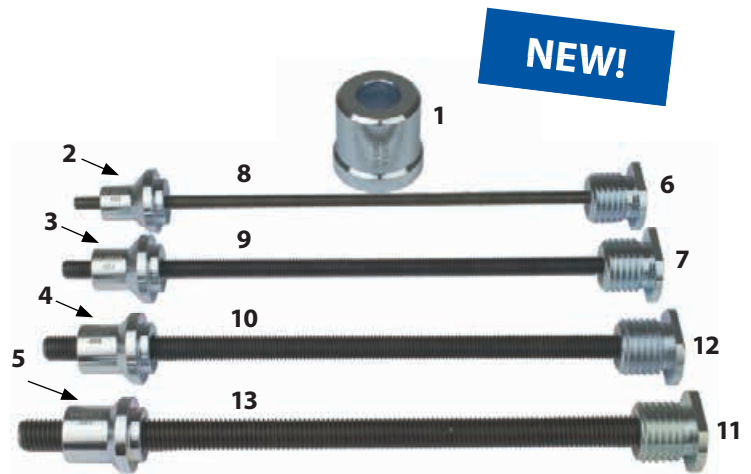

Parts in the set:

1. 04-00018-001 - Press pipe universal
2. 04-00018-002 - Rivet tube M6
3. 04-00018-003 - Rivet tube M8
4. 04-00018-004 - Rivet tube M10
5. 04-00018-005 - Rivet tube M12
6. 04-00018-006 - Adaptor M22-M6
7. 04-00018-007 - Adaptor M22-M8
8. 04-00018-008 - Carriage beam M6 L=248 mm
9. 04-00018-009 - Carriage beam M8 L=248 mm
10. 04-00018-010 - Carriage beam M10 L=248 mm
11. RES4011 - Adaptor M22-M12
12. RES4012 - Adaptor M22-M10
13. RES4015 - Carriage beam M12 L=250 mm



03-00021-020, 32T and 03-00021-021, 45T Universal basic set for commercial truck and bus garages

The set comes with tools for efficient jobs on straight and conic king-pins, bushings in spring and draw bars and large lock rings. Dismounting tools for steering joints, wheel bolts, wheel hubs and slack adjusters.

NEW!



(32T)



Parts in the set:

03-00021-010, 32T

1. 2 pcs 03-00016-001 - Press foot for hub puller
2. 2 pcs 03-00003-005 - Screw M22x60 12.9 hex
3. 01-00004 - Lock ring tool
4. 04-00028 - Hydraulic ball joint puller
5. 03-00028 - Hydraulic cylinder 32 ton
6. 03-00006-013 - Press plate Ø 59 mm
7. 03-00006-014 - Press plate Ø 63 mm
8. 03-00006-015 - Press plate Ø 50 mm
9. 03-00006-016 - Press plate Ø 44 mm
10. 03-00006-017 - Press plate Ø 63 mm
11. 03-00006-018 - Press plate Ø 57 mm
12. 03-00006-021 - Press plate
13. RES4026 - Carriage beam M18/M22, 250mm
14. RES4024 - Flange nut M18
15. 03-00031-32T - Universal set for Kingpin



Parts in the set:

03-00021-011, 45T

1. 2 pcs 03-00016-001 - Press foot for hub puller
2. 2 pcs 03-00003-005 - Screw M22x60 12.9 hex
3. 01-00004 - Lock ring tool
4. 04-00028 - Hydraulic ball joint puller
5. 03-00026 - Hydraulic cylinder 45 ton
6. 03-00031-45T - Universal set for Kingpin



Storage



04-00022 Tool trolley with 9 drawers

Double tool trolley with totally 9 drawers developed for Wallmek tool sets and foams. The trolley is equipped with a large top drawer for cylinders and accessories. All drawers are locked individually and with a central lock system for extra safety during transport, storage and normal use. All drawers open fully with heavy duty ball bearing slides and can be loaded with 90 kg.

Tools not included.

Measures internal for each drawer:

- 4 pc H100×W585×D418 mm
- 3 pc H150×W585×D418 mm
- 1 pc H250×W585×D418 mm
- 1 pc H100×W1243×D418 mm (top drawer)

An extra high drawer can be ordered individually. H250×W585×D418mm.

To be used instead of the two lower drawers on the right hand side.

Outside dimensions H1060×W1350×D460 mm.

See foames on pages 47.

The large axle wheels in combination with four swiveled wheels make the trolley easy to handle also fully loaded with tools.



Large work surface.



Ball bearing slides for 90 kg load in each box!



Central lock for safe storage!

Foam for tool trolley 04-00022. Tools not included.

04-00022-009 Foam, dimension 580x415x138

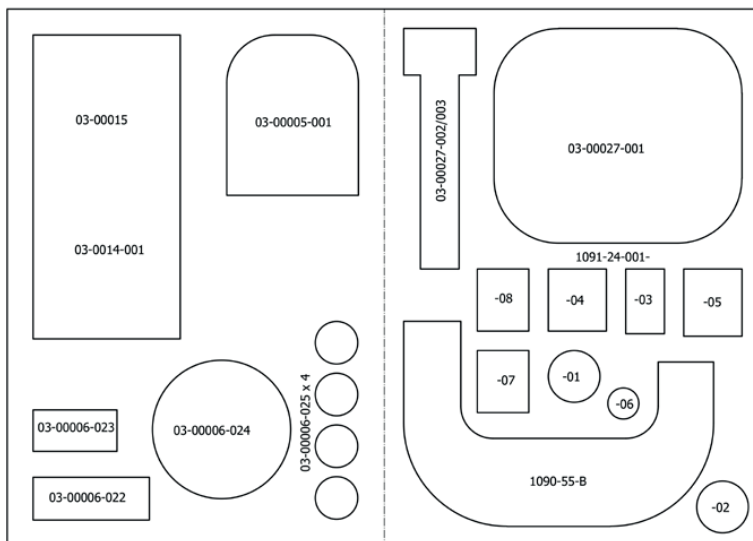

04-00022-010 Foam, dimension 580x415x218

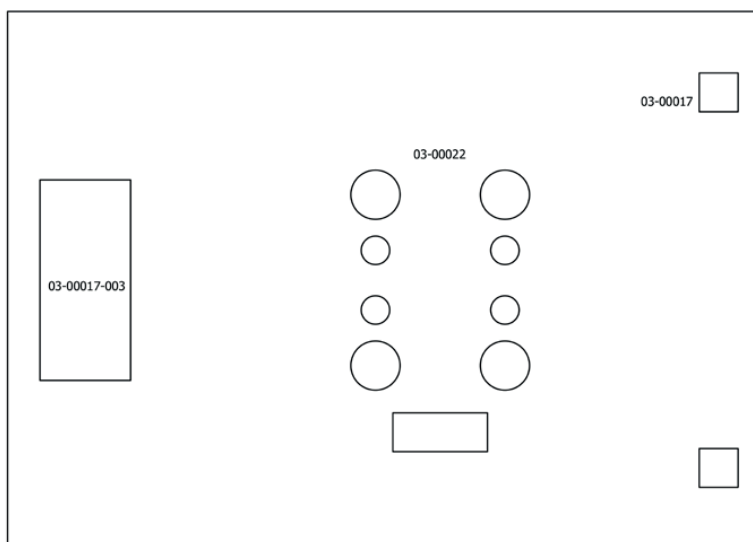

04-00022-012 Foam, dimension 580x415x100

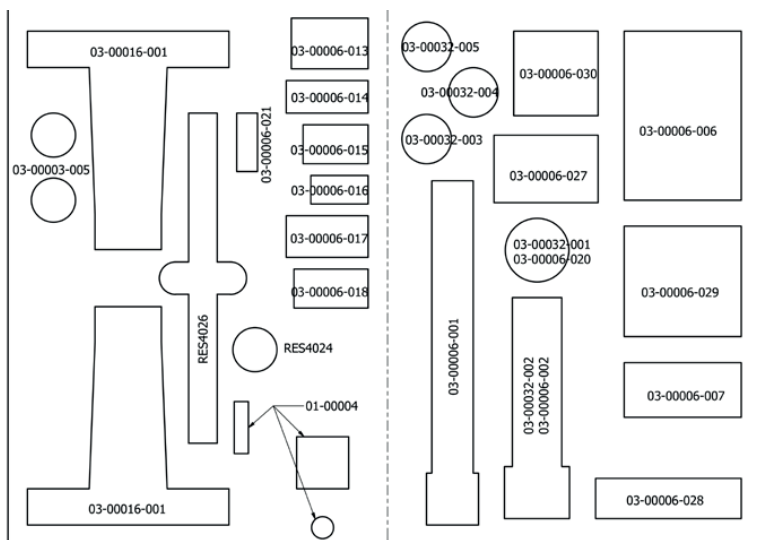

04-00022-013 Foam, dimension 580x415x90

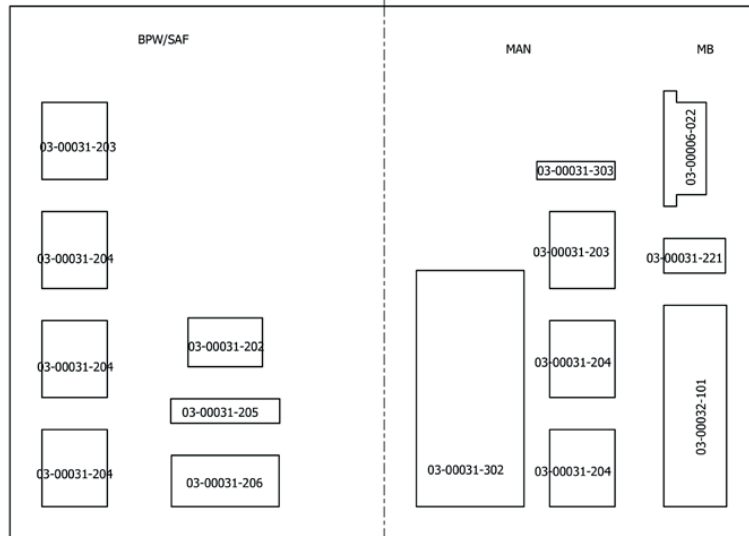

04-00022-016 Foam, dimension 580x415x122

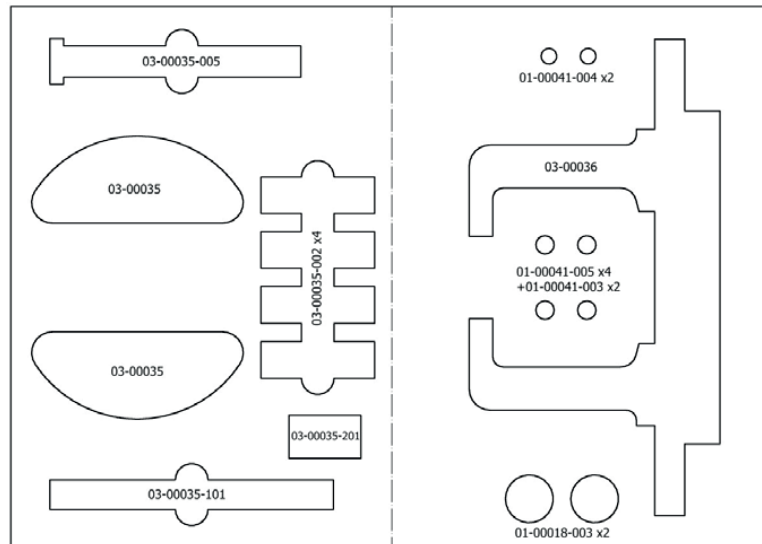

This tool and storage system is made for all automotive and truck garages that wants to take the next step in efficiency and profit. The technician can put all his time in to fixing the job instead of spending time trying to find the right tools.



1090-50 Tool cart

A sturdy construction with a large working surface. The large wheels makes it easy to transport also fully loaded.

Three different shelf/hook sets is available: 1090-51, 1090-52 and 1090-53.

Tools not included.



1090-53 Tool holder for for trucks.

04-00023 Stackable plastic tool box

A strong plastic stackable tool box for efficient storage of tools and cylinders. This solution fits also perfect when transporting the equipment between different shops.

Foams to fit in the boxes are delivered with the following tools and sets; 01-00035, 01-00022, 01-00018, 01-00026, 01-00027, 01-00033 and 01-00037.

Outer dia; 464x335x212h mm.

Inner dia; 400x300x150h mm.

The foams can also be ordered separately, see information bellow.

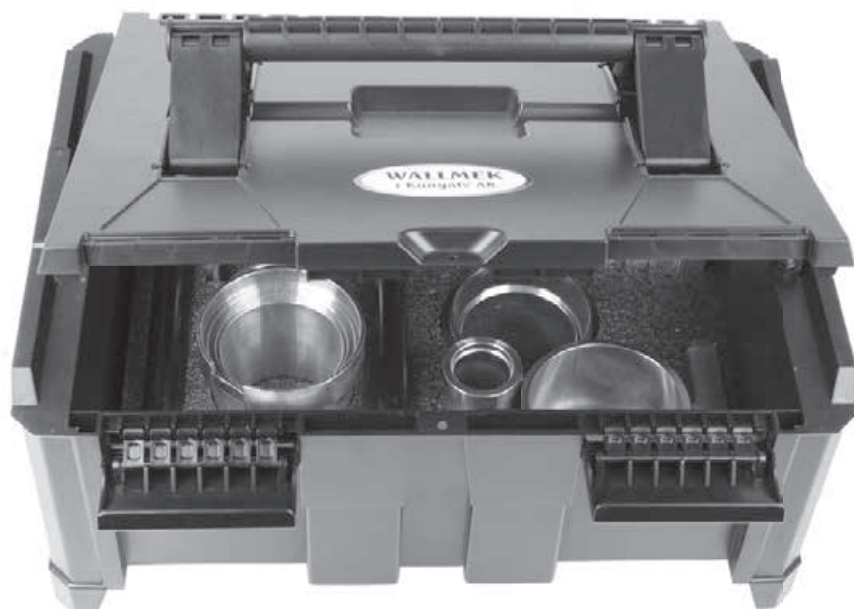

Fuel handling for Petrol, Diesel and Ethanol (E85)

An efficient and very safe way to handle fuel. This drainer has no moving pump parts, this gives a very long life time compared to mechanical devices.



L1050-E Fuel tank drainer 115L

The fuel tank drainer is made of stainless steel with a volume of 115 litres approved for petrol, diesel and ethanol. It uses vacuum when draining the car, and pressure when emptying the fuel drainer. It is delivered with a set of adaptors and a special hose for long and complicated fuel filler necks (No: L1063). The suction hose uses a quick coupling for a fast, easy and tight connection. The fuel drainer is equipped with an overfill protector, safety vent and pressure regulator. Large wheels makes it mobile and easy to move. SAQ Approval TO 194/92 – 175 950. The fuel drainer has a very long lifetime since it does not have any movable parts that can get damaged by fuel or particles. Safe, fast (max 15 l/ min) and quiet operation. Fumes are disposed of through an exhaust hose. Adaptors No: 1, 2 and 3 are included in No: L1050-E.

Comes with the drainer:

- L1054-1 Fuel refill pipe
- L1054-2 Suction adaptor, coned
- L1063 Stainless steel hose with quick coupling for draining fuel through long, bent and complicated fuel tank filler necks with L1050 and L1050-E.
Diameter: 12mm. Length: 1,9m. Suction capacity: 7 litres/min.



05-0009 Fuel drainer for trucks and busses

The fuel suction unit is intended, approved and EX classed for ethanol, diesel and petrol. It is equipped with 4 wheels but it can also be handled using a pallet lifter or a fork lifter. The fuel suction unit is made from stainless steel. Its capacity is 630 liters and it weighs 145 kg when empty. The fuel suction unit is powered by a pneumatic diaphragm pump that drains and fills with 20 lit/min. An overfill protection device automatically breaks the air supply to the pump if the fuel level in the fuel suction unit is too high.

The fuel suction unit is equipped with a bleed hose fitted with a flame guard, which is connected to the vehicle exhaust extraction system when draining vehicles to achieve odorless fuel handling.

The unit is supplied with three suction and filler adaptors.

1. L1054-1 Fuel refill 15 litres/min
2. 05-0009-002 Fuel hose ½", 3 m
3. 05-0009-003 Adaptor Tema 1800 – Parker NS

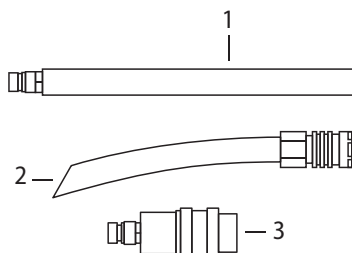

630L



L2015 Water separator Petrol, Diesel and Ethanol (E85)

Cleans petrol and diesel effectively from water and particles.

For mounting on fuel tank drainer no: L1050-E.

Easy inspection through sight glass.



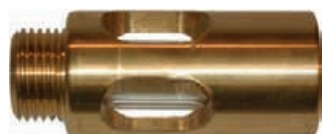

Drains from bottom valve. Volume 3,5 litres.

Picture shows separator mounted on fuel tank drainer.



05-00001 Liquid indicator 1/2"

For mounting on the fuel tank drainer fuel hose. 1/2" pipe thread.

-  **Passenger cars**
-  **Light Commercial**
-  **Trucks**
-  **Fuel handling**
-  **Car dismantling**

Address

Bultgatan 18
442 40 Kungälv
Sweden

Contact

Phone: +46 (0)303 - 585 80
Fax: +46 (0)303 - 942 46
E-mail: info@wallmek.se

Distributor



www.wallmek.se